

RETAIL / SERVICE STRATEGIC AREA - DOWNTOWN RIVER DISTRICT (EASTSIDE & WESTSIDE TIF DISTRICTS)

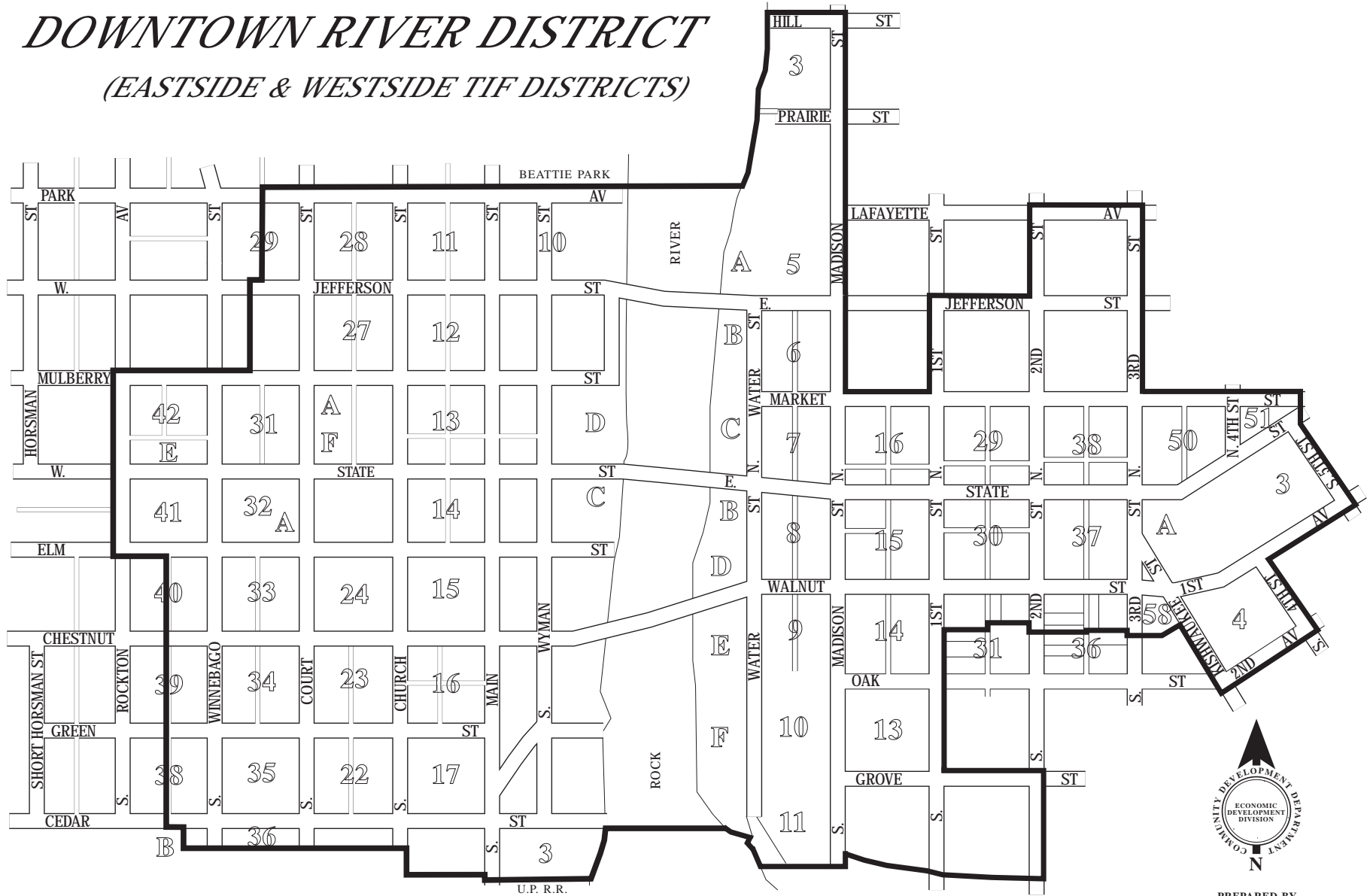

— BOUNDARY LINE



PREPARED BY
DEPARTMENT OF COMMUNITY DEVELOPMENT
PLANNING DIVISION
GEORGE G. ADAMS JR.
SEPTEMBER, 1979
REVISED NOVEMBER, 1999
REVISED OCTOBER 2003